

PARTITION TYPES - (NOT ALL TYPES ARE USED WITHIN PROJECT)

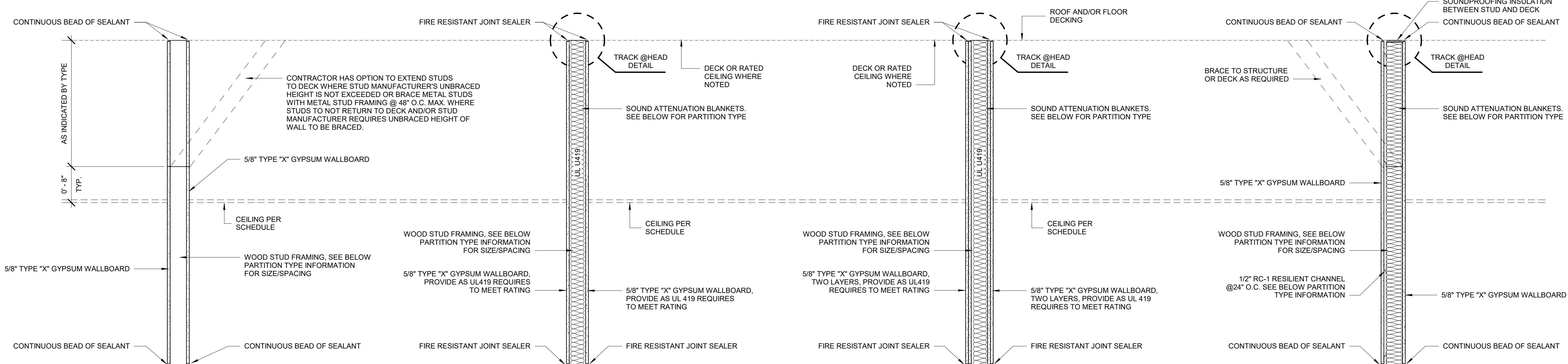

S1 - TYPICAL WOOD STUD

- S1.1 - 3 1/2" WOOD STUD - 16" O.C. - 8" ABOVE CEILING  
S1.2 - 5 1/2" WOOD STUD - 16" O.C. - 8" ABOVE CEILING

S2 - 1 HOUR FIRE RATED WOOD STUD

- S2.1 - 3 1/2" WOOD STUD - 16" O.C. - 1 HR RATED TO DECK - UL U309  
S2.2 - 5 1/2" WOOD STUD - 16" O.C. - 1 HR RATED TO DECK - UL U309  
S2.3 - 7 1/4" WOOD STUD - 16" O.C. - 1 HR RATED TO DECK - UL U309  
S2.7 - 3 1/2" WOOD STUD - 16" O.C. - 1 HR RATED TO RATED SHAFT WALL CEILING

S2 - 2 HOUR FIRE RATED WOOD STUD

- S2.4 - 3 1/2" WOOD STUD - 16" O.C. - 2 HR RATED TO DECK - UL U309  
S2.5 - 5 1/2" WOOD STUD - 16" O.C. - 2 HR RATED TO DECK - UL U309  
S2.6 - 7 1/4" WOOD STUD - 16" O.C. - 2 HR RATED TO DECK - UL U309

S3 - SOUND RATED WOOD STUD

- S3.1 - 3 1/2" WOOD STUD W/ RC-1 CHANNEL - 16" O.C. - TO DECK - STC 54  
S3.2 - 5 1/2" WOOD STUD W/ RC-1 CHANNEL - 16" O.C. - TO DECK - STC 54  
S3.3 - 3 1/2" WOOD STUD WITHOUT RC-1 CHANNEL - 16" O.C. - TO DECK - STC 48  
S3.4 - 5 1/2" WOOD STUD WITHOUT RC-1 CHANNEL - 16" O.C. - TO DECK - STC 48  
S3.5 - 3 1/2" WOOD STUD WITHOUT RC-1 CHANNEL - 16" O.C. - 8" ABOVE CEILING - STC 48  
S3.6 - 5 1/2" WOOD STUD WITHOUT RC-1 CHANNEL - 16" O.C. - 8" ABOVE CEILING - STC 48

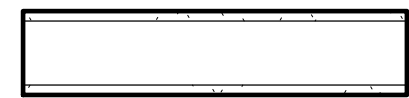

PLAN VIEW

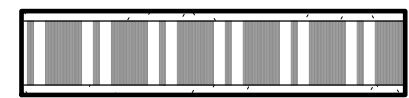

PLAN VIEW

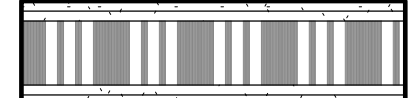

PIPLAN VIEW

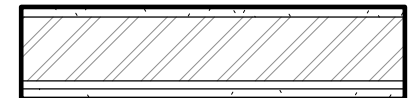

PLAN VIEW

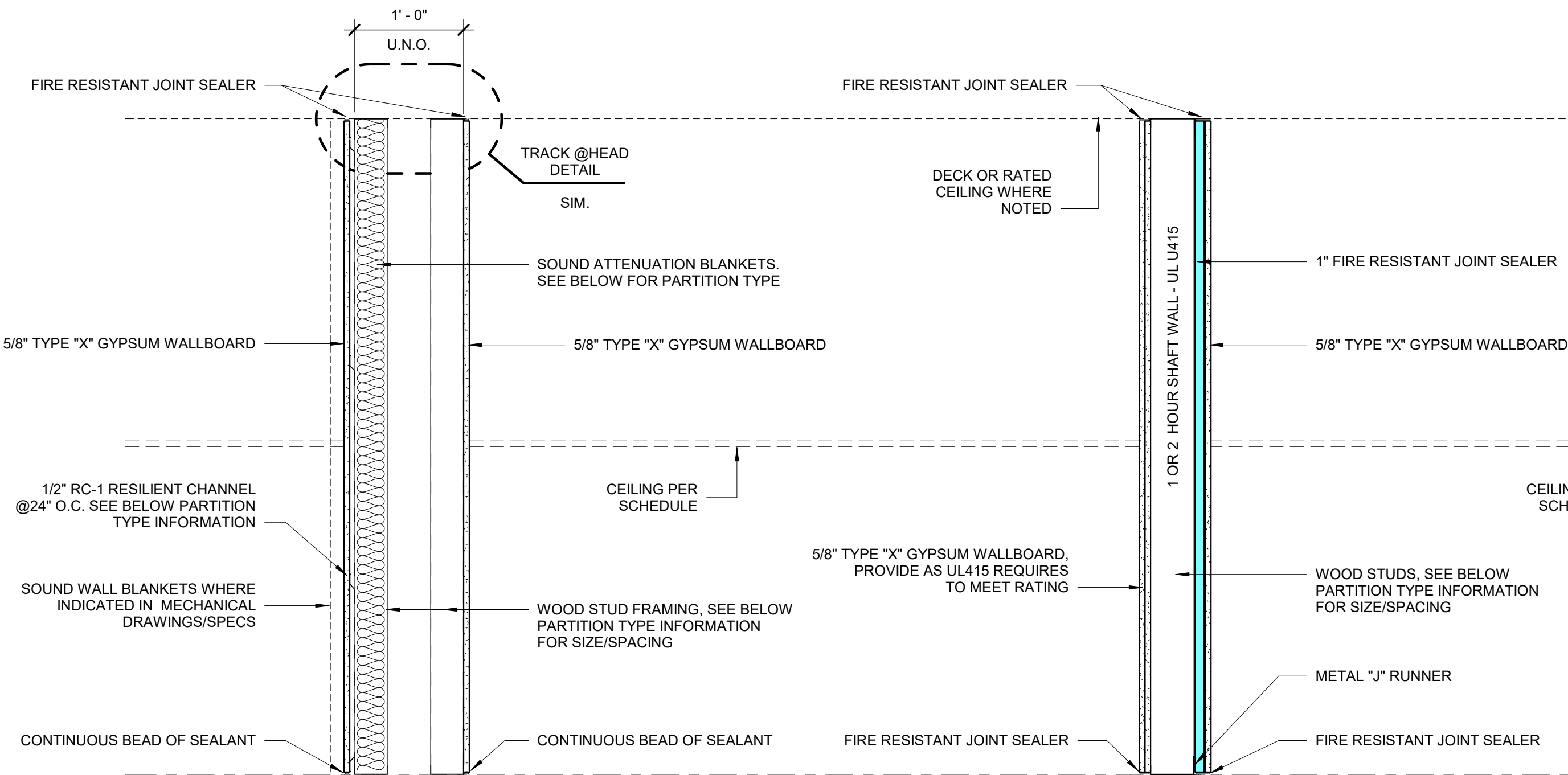

S4 - CHASE WALL

- S4.1 - DOUBLE 3 5/8" WOOD STUD - 16" O.C. - CHASE WALL  
S4.2 - DOUBLE 3 5/8" WOOD STUD - 16" O.C. W/ SOUND BLANKETS ON FACE AND SOUND BATTS INSULATION IN WALL - CHASE WALL  
S4.3 - DOUBLE 3 5/8" WOOD STUD - 16" O.C. W. RC-1 CHANNEL AND SOUND BATT INSULATIONS - CHASE WALL

S5 - SHAFT METAL STUD

- S5.1 - 2.5" C-H STUD SHAFTWALL - 16" O.C. - 1 HOUR RATED TO DECK - UL U415  
S5.2 - 3 5/8" C-H STUD SHAFTWALL - 16" O.C. - 1 HOUR RATED TO DECK - UL U415  
S5.3 - 6" C-H STUD SHAFTWALL - 16" O.C. - 1 HOUR RATED TO DECK - UL U415  
S5.4 - 2.5" C-H STUD SHAFTWALL - 16" O.C. - 2 HOUR RATED TO DECK - UL U415  
S5.5 - 3 5/8" C-H STUD SHAFTWALL - 16" O.C. - 2 HOUR RATED TO DECK - UL U415  
S5.6 - 6" C-H STUD SHAFTWALL - 16" O.C. - 2 HOUR RATED TO DECK - UL U415

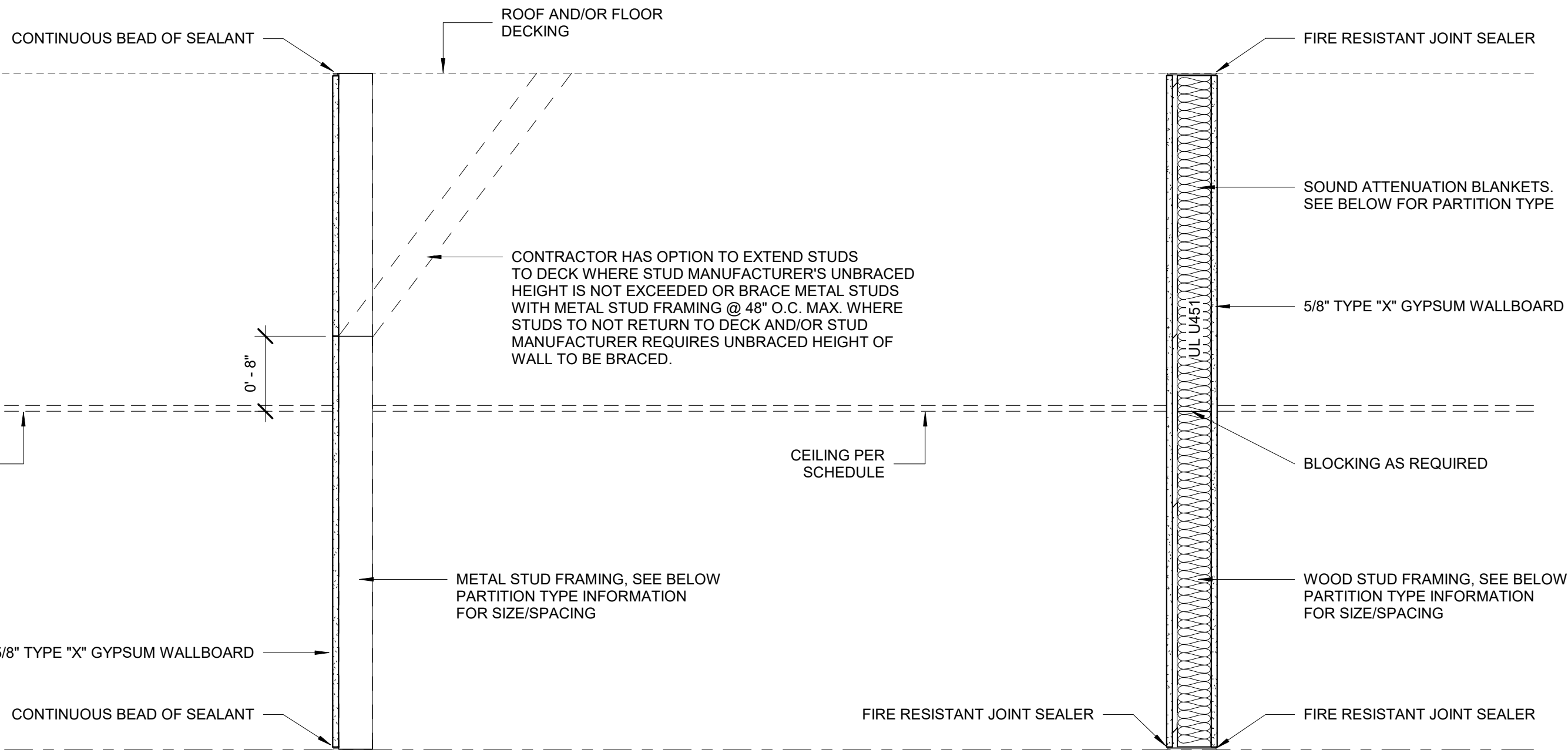

S6 - SINGLE SIDE GYPSUM WOOD STUD

- S6.1 - 2 1/2" WOOD STUD SINGLE SIDED GYP. - 16" O.C. - 8" ABOVE CEILING  
S6.2 - 2 1/2" WOOD STUD SINGLE SIDED GYP. - 16" O.C. - TO DECK  
S6.3 - 3 1/2" WOOD STUD SINGLE SIDED GYP. - 16" O.C. - 8" ABOVE CEILING  
S6.4 - 3 1/2" WOOD STUD SINGLE SIDED GYP. - 16" O.C. - TO DECK  
S6.5 - 5 1/2" WOOD STUD SINGLE SIDED GYP. - 16" O.C. - 8" ABOVE CEILING  
S6.6 - 5 1/2" WOOD STUD SINGLE SIDED GYP. - 16" O.C. - TO DECK

S9 - FIRE RATED SOUND WALL

- S9.1 - 3 1/2" WOOD STUD - 16" O.C. - 1 HR RATED W/ RC-1 CHANNEL TO DECK - UL U451 - STC 54  
S9.2 - 3 1/2" WOOD STUD - 16" O.C. - 2 HR RATED W/ RC-1 CHANNEL TO DECK - UL U419 - STC 54  
S9.3 - 5 1/2" WOOD STUD - 16" O.C. - 1 HR RATED W/ RC-1 CHANNEL TO DECK - UL U451 - STC 54  
S9.4 - 5 1/2" WOOD STUD - 16" O.C. - 2 HR RATED W/ RC-1 CHANNEL TO DECK - UL U419 - STC 54

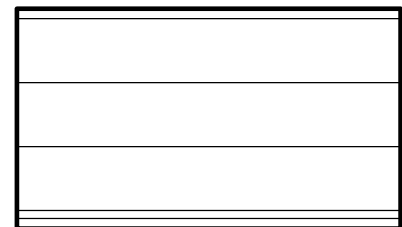

PLAN VIEW

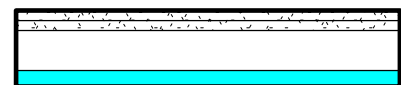

PLAN VIEW

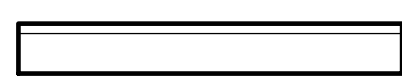

PLAN VIEW

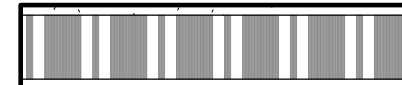

PLAN VIEW



Job Title:

Office of the State  
Public Defender  
District 8 Office  
Building

111 West Main Street  
Winnfield, LA 71483

CDMorgan

& ASSOCIATES, INC.  
ENGINEERING CONSULTANTS  
A PROFESSIONAL ENGINEERING AND ARCHITECTURAL  
CORPORATION  
LOUISIANA

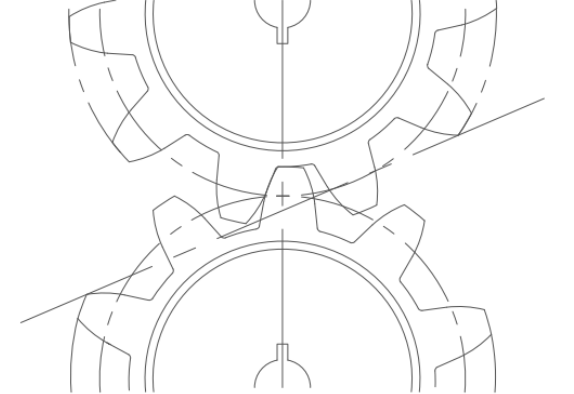

(337) 886-1280  
www.CDMorgan.com



Seal:

May 15, 2026  
Construction Documents

| No. | Description | Date |
|-----|-------------|------|
|     |             |      |
|     |             |      |
|     |             |      |
|     |             |      |
|     |             |      |
|     |             |      |
|     |             |      |
|     |             |      |
|     |             |      |

KEY PLAN

Partition Types

Project No.: BLO001-25 Drawn By: JWA

A0.3

OSPD

Sheet No.:

5/15/2026 12:02:48 PM